

EASTERN SIDE ELEVATION

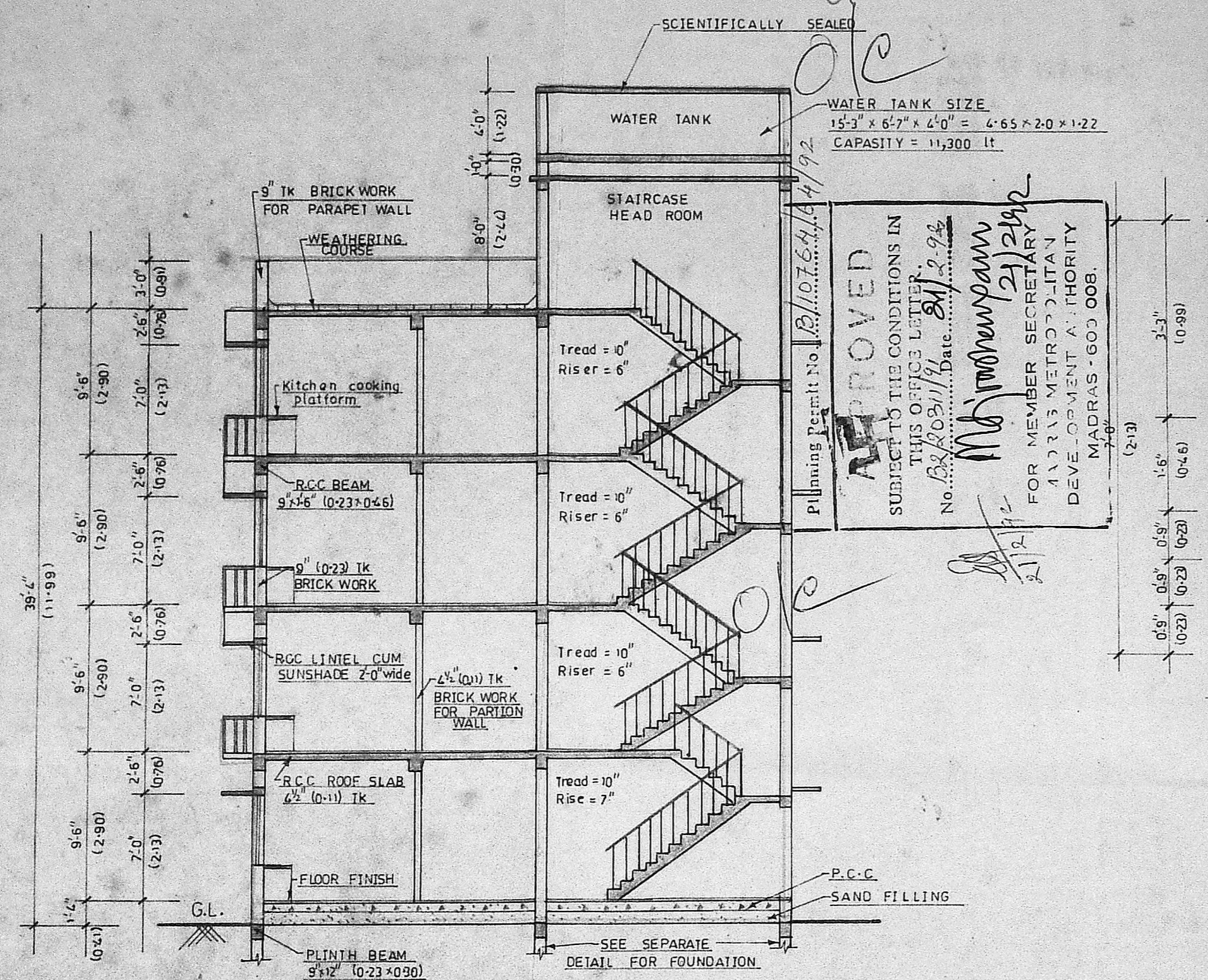

CROSS SECTION ON A-A

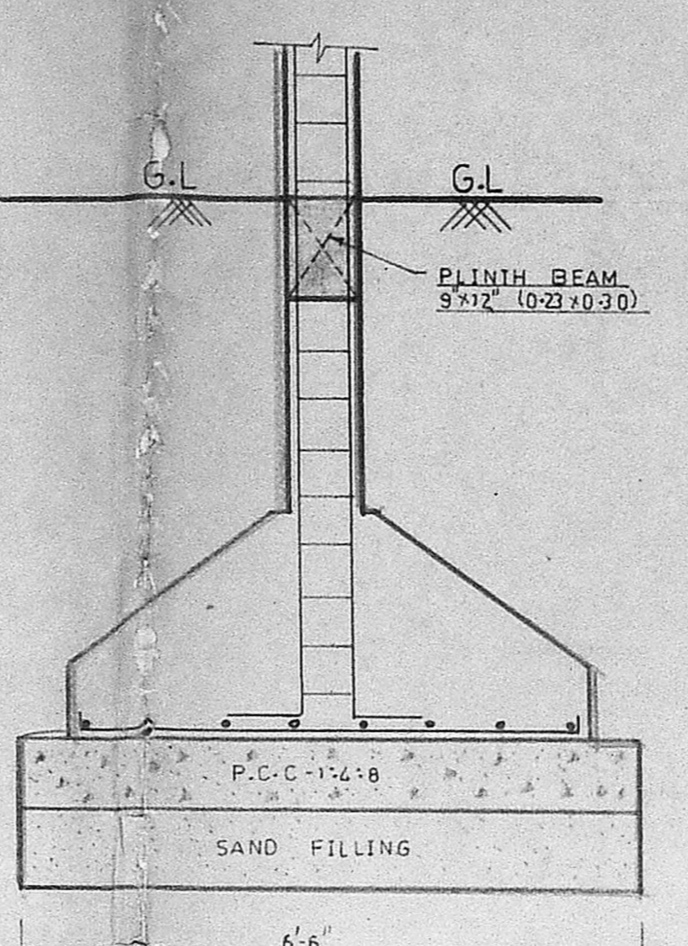

FOUNDATION DETAIL  
SCALE: 1" = 2'-0"

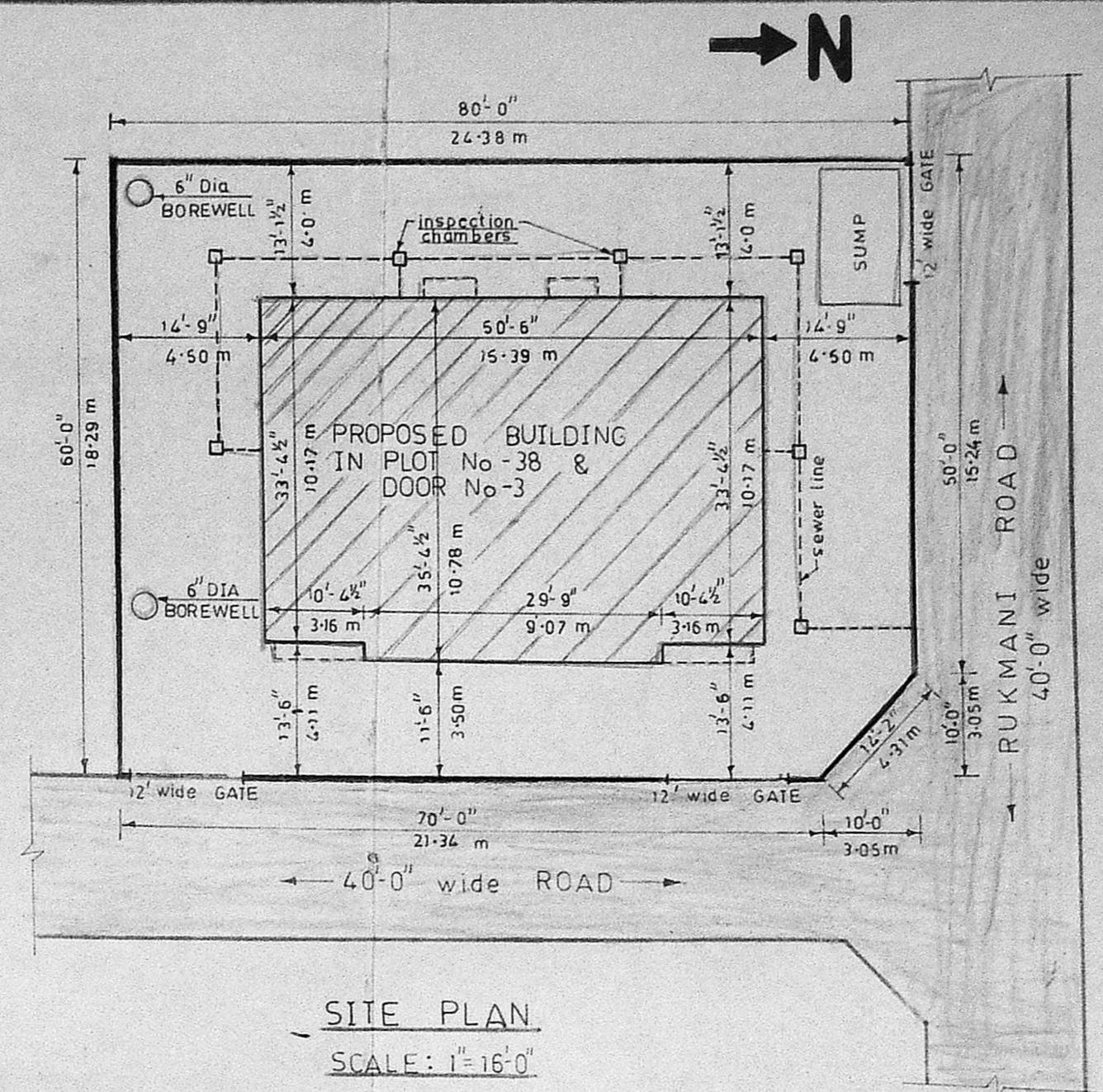

SITE PLAN  
SCALE: 1" = 16'-0"

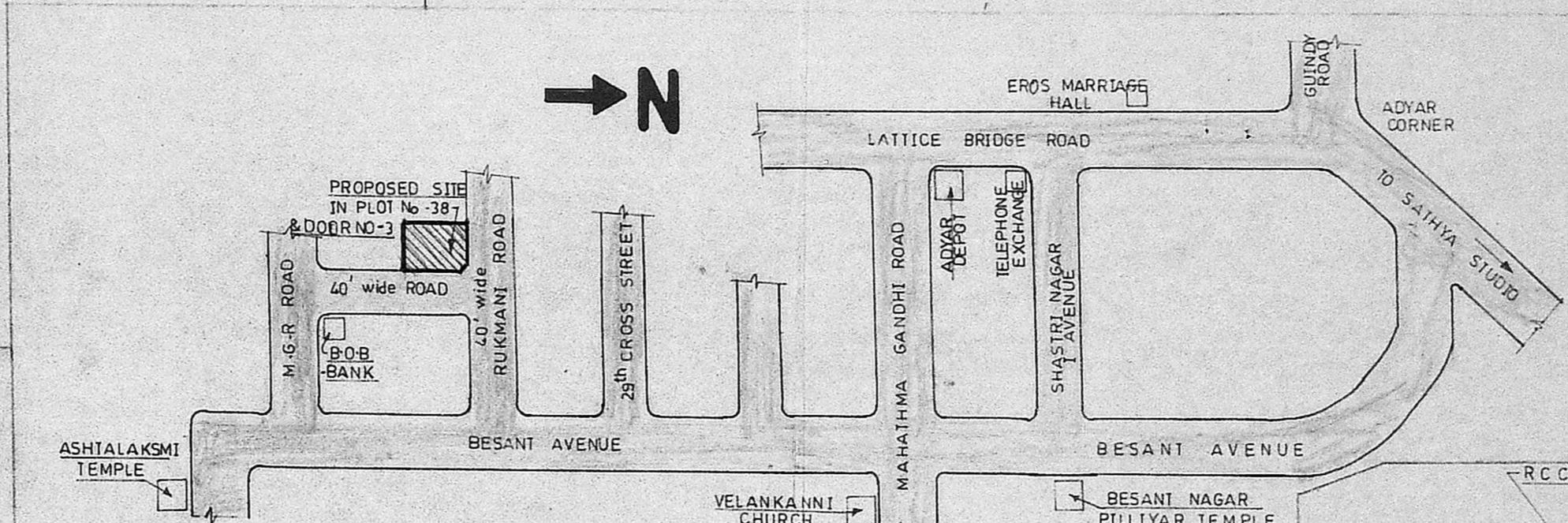

TOPO PLAN (NOT TO SCALE)

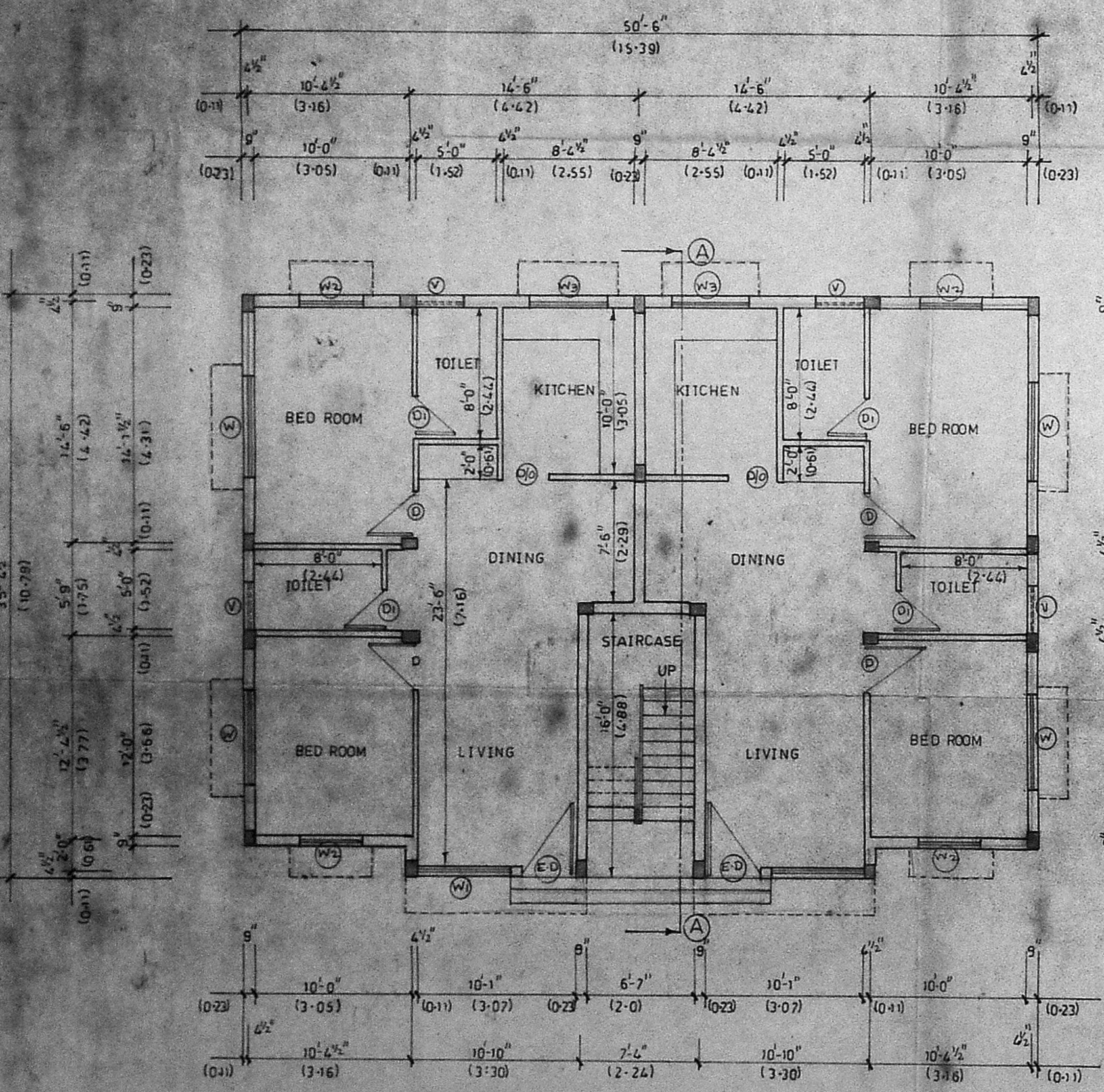

GROUND FLOOR PLAN  
SCALE: 1" = 8'-0"

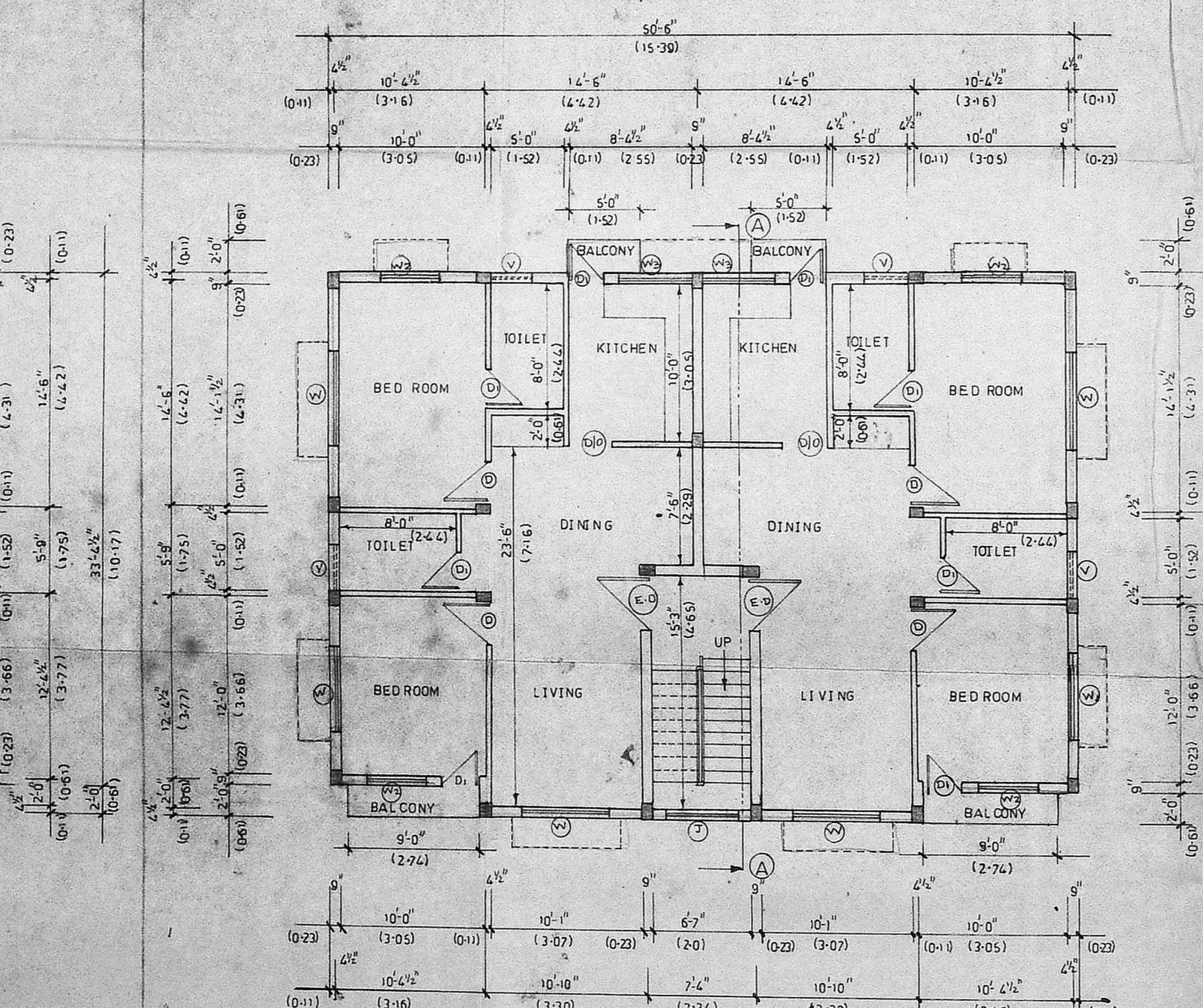

TYPICAL FLOOR PLAN FOR 1<sup>st</sup>, 2<sup>nd</sup> & 3<sup>rd</sup> FLOORS

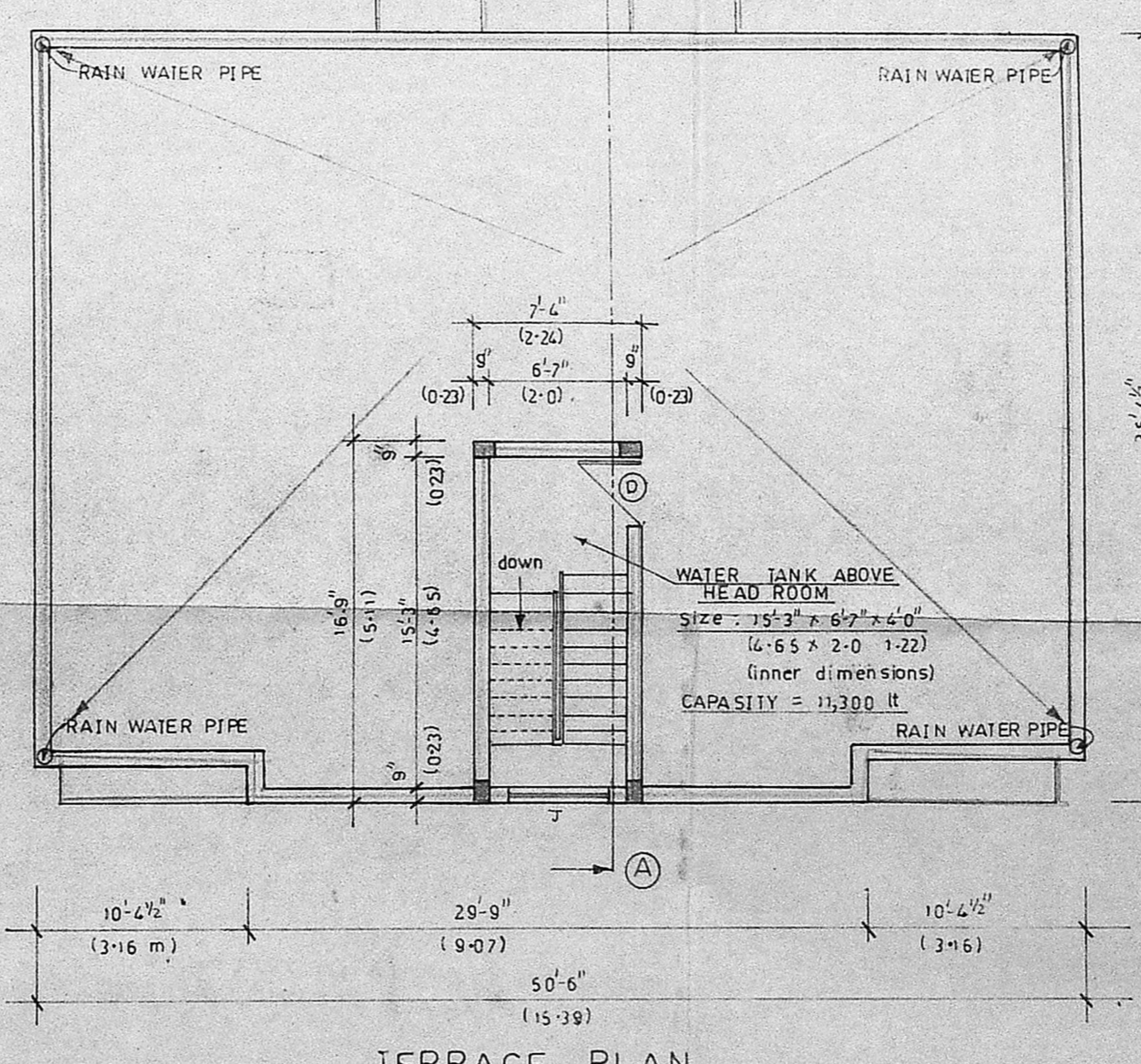

TERRACE PLAN

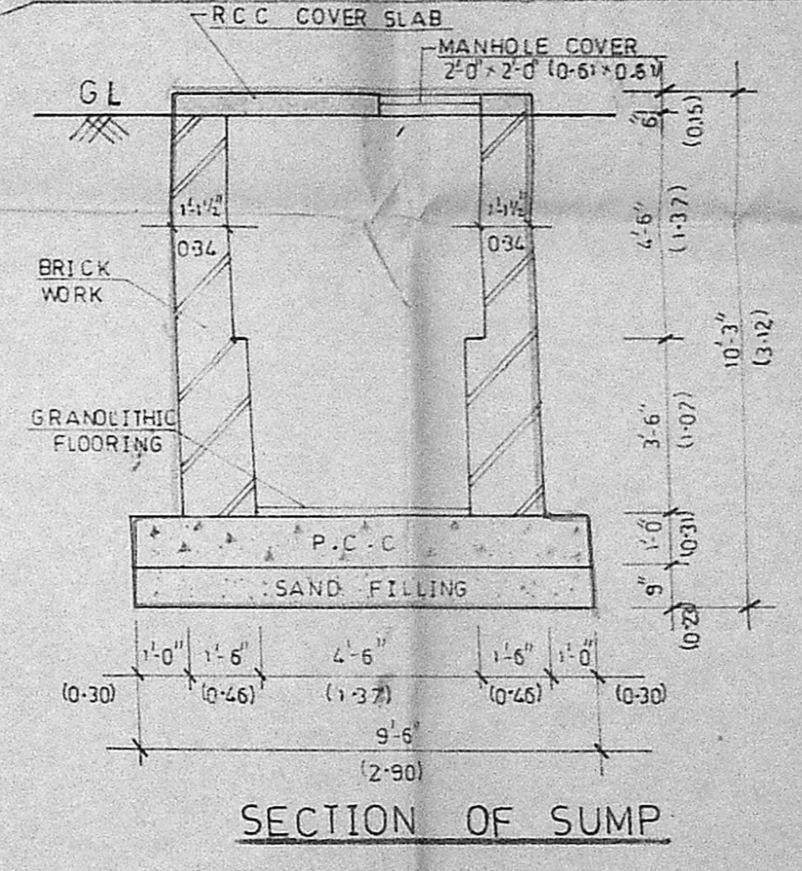

SECTION OF SUMP

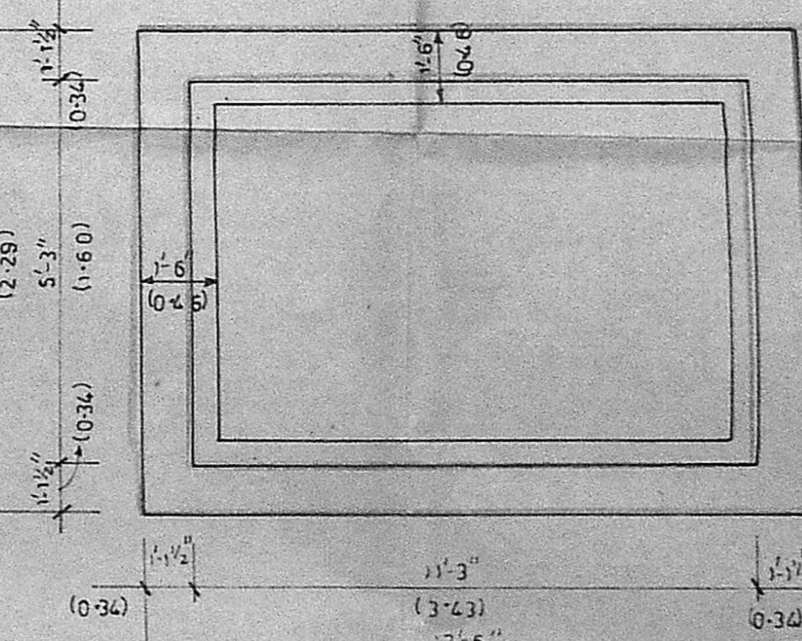

PLAN OF SUMP  
SCALE: 1" = 4'-0"

SCHEDULE OF JOINERY			
TYPE	DESCRIPTION	SIZE IN	
		FEET	METRE
E.D	T.W. ENTRANCE DOOR	3'-6" x 7'-0"	1.07 x 2.13
D	T.W. DOOR	3'-0" x 7'-0"	0.91 x 2.13
DI	-do-	2'-6" x 7'-0"	0.76 x 2.13
W	T.W. GLAZED WINDOW	6'-0" x 4'-6"	1.83 x 1.37
W1	-do-	5'-9" x 4'-6"	1.75 x 1.37
W2	-do-	4'-0" x 4'-6"	1.22 x 1.37
W3	-do-	5'-0" x 3'-6"	1.52 x 1.07
V	T.W. VENTILATOR	3'-0" x 2'-0"	0.91 x 0.61
J	R.C.C. JOLLY	5'-0" x 4'-6"	1.52 x 1.37
DJO	DOOR OPENING	3'-0" x 7'-0"	0.91 x 2.13

COLOUR REFERENCE	
PROPOSED SHOWN AS	---
PLOT BOUNDARY SHOWN AS	---
ROAD SHOWN AS	---
SEWER LINE SHOWN AS	---

AREA STATEMENT	
PLOT AREA :	= 4775.50 sq ft (443.65 m <sup>2</sup> )
F.S.I ALLOWED (1.5 TIMES THE PLOT AREA)	= 7163.25 sq-ft (665.48 m <sup>2</sup> )
PLINTH AREA OF GROUND FLOOR	= 1744.94 sq-ft (162.11 m <sup>2</sup> )
PLINTH AREA OF TYPICAL FLOORS (1 <sup>st</sup> , 2 <sup>nd</sup> & 3 <sup>rd</sup> FLOORS)	= 3 x 1800.94 sq-ft
TOTAL F.S.I USED =	(1744.94 + 5402.82) sq-ft
	= 7147.76 sq-ft (664.04 m <sup>2</sup> )
NON F.S.I AREAS	
STAIRCASE HEAD ROOM	= 122.83 sq-ft (11.41 m <sup>2</sup> )
WATER TANK	= 122.83 sq-ft (11.41 m <sup>2</sup> )
CAR PARKING SPACE PROVIDED -NIL-	
TWO WHEELER PARKING SPACE PROVIDED.	

SCALES USED: 1" = 2'-0", 1" = 8'-0", 1" = 16'-0" & 1" = 4'-0"

LICENSED SURVEYOR  
*Uthayakumar*  
R.P. KALPATE & CO. (P) LTD.  
CORPORATION APPROVED LICENSED SURVEYOR  
(Class I) (M) No. 100/199  
15, III AVENUE, ANDHRA NAGAR  
MADRAS - 600 050

OWNER  
*Saroja Mani*

PROPOSED RESIDENTIAL APARTMENT  
FOR Mrs. SAROJA MANI AT PLOT No-38  
& DOOR No-3 AT RUKMANI ROAD,  
S.No-161/2 & 3 Part, DIV. No-150  
BESANT NAGAR, MADRAS-600090.